

Sub: Aug. 16th, 2012

FOR SURVEY CONTROL DATA
SEE SURVEY DATA SHEETS.

STATE OF OKLAHOMA
DEPARTMENT OF TRANSPORTATION

PLAN OF PROPOSED
U.S. HIGHWAY 177

PROJECT NO. STPY-160B(135)

STATE NO. JP 21932(04)

SURFACING, GRADING, DRAINAGE & SIGNALS
PAYNE COUNTY

CONTROL SECTION: 177-60-12 (U.S.177)
33-60-06 (S.H.33)

REV. NO.	DATE	DESCRIPTION
6	OKLA.	

INDEX OF SHEETS

1	TITLE SHEET
2-12	TYPICAL SECTIONS
13	GENERAL CONSTRUCTION NOTES
14	SUMMARY OF PAY QUANTITIES (ROADWAY QUANTITIES)
15	SUMMARY OF PAY QUANTITIES (ROADWAY NOTES)
16	SUMMARY OF PAY QUANTITIES (TRAFFIC)
17	US-177 AT SH-33 AND AT FREEMAN QUANTITIES AND NOTES
22	SUMMARY SHEET
23-30	SUMMARY OF DRAINAGE
31-36	MASS DIAGRAM
37	STORM WATER MANAGEMENT PLAN
38-46	EROSION CONTROL DETAIL
47	OVERALL DRAINAGE MAP
48-50	DRAINAGE MAP
51-52	CIMARRON DITCH PLAN AND PROFILE
53-61	U.S. 177 PLAN & PROFILE
62	JARDOT ROAD PLAN & PROFILE
63-67	HWY. 33 PLAN & PROFILE
68-79	CITY STREET PLAN & PROFILE
80-83	EAST & WEST ALLEY PLAN SHEET
84-91	STORM SEWER LINE "A" PLAN & PROFILE
92-99	GEOMETRIC PLAN
100-129	SUGGESTED CONSTRUCTION SEQUENCE
130-134	SIGNING & STRIPING PLAN
135	SIGN DETAILS
136-142	REMOVAL PLAN
143-144	INTERSECTION DETAILS
145-159	SURVEY DATA SHEET
160	DETENTION FACILITY PLAN VIEW
161	DETENTION FACILITY DRIVE
162	PRIVATE DRIVES PLAN VIEW
163-174	SPECIAL DRAINAGE STRUCTURE DETAILS
175	US-177 (MAIN ST.) & SH-33 SIGNAL PLAN
176	US-177 (MAIN ST.) & SH-33 SIGNAL DETAIL
177	US-177 (MAIN ST.) & SH-33 WIRING DIAGRAM
178	US-177 (MAIN ST.) & FREEMAN AVE. SIGNAL PLAN
179	US-177 (MAIN ST.) & FREEMAN AVE. SIGNAL DETAIL
180	US-177 (MAIN ST.) & FREEMAN AVE. WIRING DIAGRAM
X01-X10	CIMARRON DITCH CROSS SECTIONS
X11-X57	U.S. 177 CROSS SECTIONS
X58-X75	S.H. 33 CROSS SECTIONS
X76-X79	JARDOT ROAD CROSS SECTIONS
X80-X149	STORM SEWER LINE "A" CROSS SECTIONS
X150-X177	DETENTION FACILITY CROSS SECTIONS

DESIGN DATA

ADT 2012	=	8,659
ADT 2032	=	12,867
K (DHV/ADT)	=	11%
D	=	55%
T (% DHV)	=	5%
T (%AADT)	=	9%
T3 (%AADT)	=	5%
V (S.H. 33)	=	45 MPH
V (U.S. 177 NORTH)	=	40 MPH
V (U.S. 177 SOUTH)	=	65 MPH
V (FIRST ST.)	=	25 MPH
20 yr. Flex ESALS	=	9.2 Million

LOCATION MAP

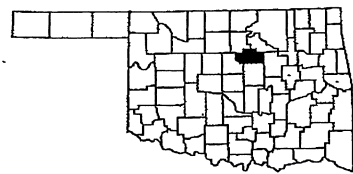

SCALE

PLAN 1" = 30'
PROFILE HOR. 1" = 30'
VER. 1" = 5'
LAYOUT MAP 1" = 2500'
LEVEL DATUM IS MEAN SEA LEVEL (U.S.C. & G.S.)
BEARINGS ARE GRID BEARINGS IN THE O.S.H.D.
PLANE COORDINATE SYSTEM.

CONVENTIONAL SIGNS

	PROPOSED ROAD
	RAILROADS
	RANGE & TOWNSHIP LINES
	SECTION LINES
	QUARTER SECTION LINES
	FENCES
	GROUND LINE
	EXISTING ROADS
	BASE LINE
	GRADE LINES
	TELEPHONE & TELEGRAPH
	POWER LINES
	OIL WELLS
	BUILDINGS
	DRAINAGE STRUCTURES-IN-PLACE
	DRAINAGE STRUCTURES-NEW
	RIGHT-OF-WAY LINES-EXISTING
	RIGHT-OF-WAY LINES-NEW
	RIGHT-OF-WAY MARKERS-IN PLACE
	RIGHT-OF-WAY MARKERS-REMOVE & RESET
	RIGHT-OF-WAY MARKERS-NEW
	CONTROLLED ACCESS
	EXISTING SANITARY SEWERS
	EXISTING GAS LINES
	EXISTING WATER LINES
	EXISTING TELEPHONE CABLES UNDERGROUND
	INTERSTATE HIGHWAY
	U.S. HIGHWAY
	STATE HIGHWAY

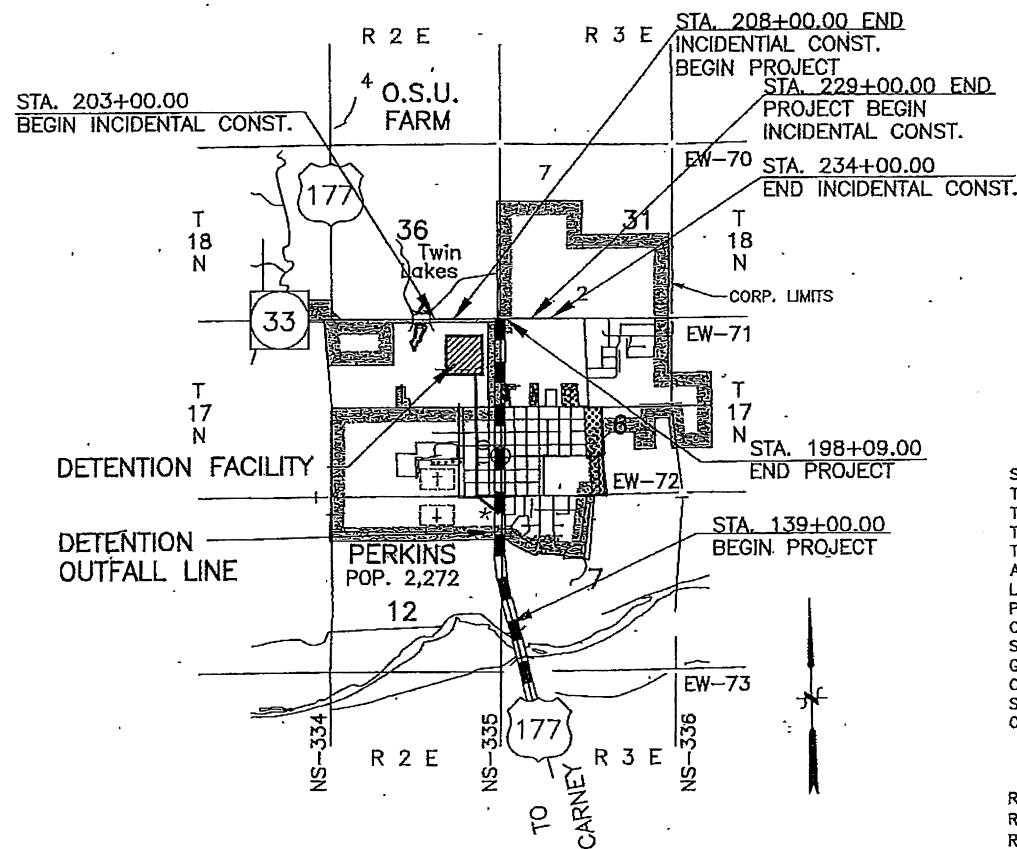

THE FOLLOWING ODOT STANDARDS WILL BE REQUIRED:

ROADWAY:	TRAFFIC SIGNALS:	TRAFFIC CONTROL:	TRAFFIC LIGHTING:
SSS-1-1	MJB-3-1	PMAP1-1-00	TCS1-1-01
TSC1-3-0	SPI-4-0	SA1-1-01	TCS2-1-00
TSC2-3-0	SPB-1-2	SNS1-1-01	TCS3-1-01
TSD-2-0	FHTMP-5-0	TSSS1-1-00	TCS4-1-01
TRFD1-1	FHTCP-3-0	PWD1-1-00	TCS5-1-00
ASCD-5-1	SBI-4-1	CFD1-1-00	TCS6-1-02
LECS-4-0	MI-3-0	CC1-1-00	TCS7-1-01
PED-3-1	RDI-3-1	TSSP1-1-00	TCS8-1-00
CDIB-1-0	DC-3-2	SWD1-1-00	TCS9-1-01
SMD-3-0	PDT-1-1		TCS10-1-00
GPI-4-0	RWF1-2-1		
CI-1-1	RWF2-2-0		
SSIF-4-0	RWF3-2-1		
CIG-3-0	WCR-3-1		
	TWD-1-0		

BRIDGE:
RCB-C1-6(2-14)-01E
RCB-C1-10(2-14)-01E
RCB-C1-12(2-14)-01E
RCB-C1-14(2-10)-01E

ROADWAY LENGTH (S.H. 33)	3100.00 FT.	0.587 MI.
ROADWAY LENGTH (U.S. 177)	5909.00 FT.	1.119 MI.
PROJECT LENGTH	9009.00 FT.	1.706 MI.

circa 2012

2009 OKLAHOMA STANDARD SPECIFICATIONS FOR HIGHWAY CONSTRUCTION-ENGLISH GOVERN, APPROVED BY THE U.S. DEPARTMENT OF TRANSPORTATION, FEDERAL HIGHWAY ADMINISTRATION, JANUARY 4, 2010.

OKLAHOMA DEPARTMENT OF TRANSPORTATION	DEPARTMENT OF TRANSPORTATION FEDERAL HIGHWAY ADMINISTRATION
DATE APPROVED _____	DATE APPROVED _____
BY _____ CHIEF ENGINEER	BY _____ DIVISION ADMINISTRATOR
SWO4124(1)	STATE JOB NO. JP 21932(04) SHEET NO. 1

For Information Only --- Earlier Project Plans in Perkins.